

# JAM6

60/250-270

MONOCRYSTALLINE SILICON MODULE

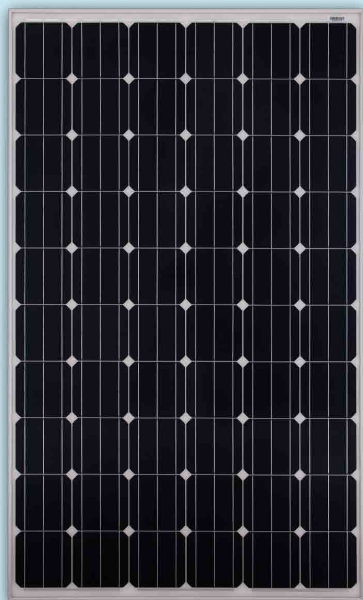

## JA Solar Holdings Co., Ltd.

JA Solar Holdings Co., Ltd. is a world-leading manufacturer of high-performance photovoltaic products that convert sunlight into electricity for residential, commercial, and utility-scale power generation. The company was founded on May 18, 2005, and was publicly listed on NASDAQ on February 7, 2007. JA Solar is one of the world's largest producers of solar cells and modules. Its standard and high-efficiency product offerings are among the most powerful and cost-effective in the industry.

Address: NO.36, Jiang Chang San Road, Zhabei, Shanghai 200436, China  
 Tel: +86 21 6095 5888 / +86 21 6095 5999  
 Fax: +86 21 6095 5858 / +86 21 6095 5959  
 Email: sales@jasolar.com market@jasolar.com

## Superior Warranty

- 10-year product warranty
- 25-year linear power output warranty

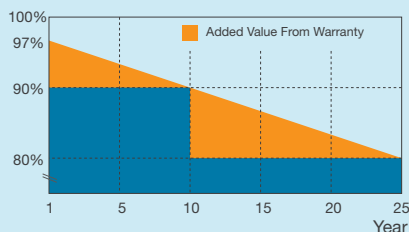

## Key Features



Monocrystalline modules designed for residential and utility applications, rooftop or ground mount



The latest module manufacturing technology, high power output and highest conversion efficiency of 16.21%



Anti-reflective and self-cleaning surface reduces power loss from dirt and dust



Outstanding performance in low-light irradiance environments



Excellent mechanical load resistance: Certified to withstand high wind loads (2400Pa) and snow loads (5400Pa)



High salt and ammonia resistance certified by TÜV NORD

## Reliable Quality

- Positive power tolerance: 0~+5W
- 100% EL double-inspection ensures modules are defects free
- Modules binned by current to improve system performance
- Potential Induced Degradation (PID) free

## Comprehensive Certificates

- IEC 61215, IEC 61730, UL1703, CEC Listed, MCS and CE
- ISO 9001: 2008: Quality management systems
- ISO 14001: 2004: Environmental management systems
- BS OHSAS 18001: 2007: Occupational health and safety management systems
- Environmental policy: The first solar company in China to complete Intertek's carbon footprint evaluation program and receive green leaf mark verification for our products



Specifications subject to technical changes and tests. JA Solar reserves the right of final interpretation.

## Engineering Drawings

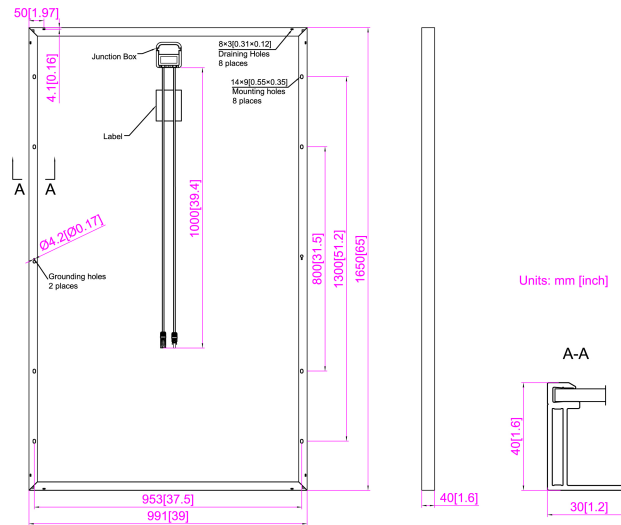
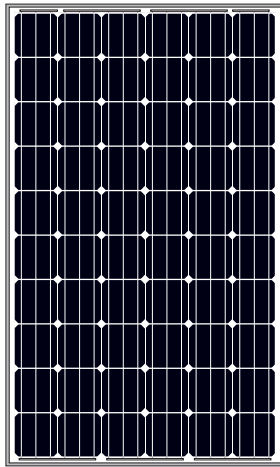

MECHANICAL PARAMETERS	
Cell (mm)	Mono 156×156
Weight (kg)	18.5 (approx)
Dimensions (L×W×H) (mm)	1650×991×40
Cable Cross Section Size (mm <sup>2</sup> )	4
No. of Cells and Connections	60 (6×10)
No. of Diodes	3 or 6 (2 in parallel)
Junction Box Connector	MC4 Compatible
Packaging Configuration	26/26+2 Per Pallet

WORKING CONDITIONS	
Maximum System Voltage	DC 1000V (TÜV) / 600V (UL) / 1000V (ETL)
Operating Temperature	-40°C~+85°C
Maximum Series Fuse	15A
Maximum Static Load, Front (e.g., snow and wind)	5400Pa (112 lb/ft <sup>2</sup> )
Maximum Static Load, Back (e.g., wind)	2400Pa (50 lb/ft <sup>2</sup> )
NOCT	45±2°C
Application Class	Class A

## I-V CURVE

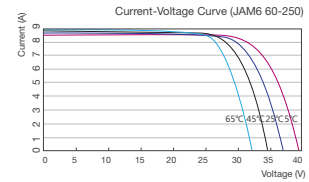
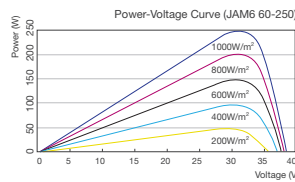
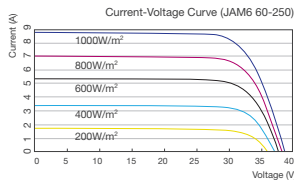

## ELECTRICAL PARAMETERS

TYPE	JAM6 60-250/SI	JAM6 60-255/SI	JAM6 60-260/SI	JAM6 60-265/SI	JAM6 60-270/SI
Rated Maximum Power at STC (W)	250	255	260	265	270
Open Circuit Voltage (Voc/V)	37.88	38.1	38.24	38.38	38.62
Maximum Power Voltage (Vmp/V)	30.35	30.62	30.98	31.24	31.54
Short Circuit Current (Isc/A)	8.66	8.72	8.76	8.8	8.82
Maximum Power Current (Imp/A)	8.24	8.31	8.39	8.48	8.56
Module Efficiency [%]	15.29	15.59	15.90	16.21	16.51
Power Tolerance (W)			-0~+5W		
Temperature Coefficient of Isc (αIsc)			+0.049%/°C		
Temperature Coefficient of Voc (βVoc)			-0.340%/°C		
Temperature Coefficient of Pmax (γPmp)			-0.430%/°C		
STC	Irradiance 1000W/m <sup>2</sup> , Module Temperature 25°C, Air Mass 1.5				

Electrical data in this catalog do not refer to a single module and they are not part of the offer. They only serve for comparison among different module types.